

---

**WATER QUALITY TESTING**

**FOR**

**BASSC**

**ELEMENTARY SCHOOL**

**NOVEMBER 22, 2017**

**PROJECT NUMBER: 17-18340**

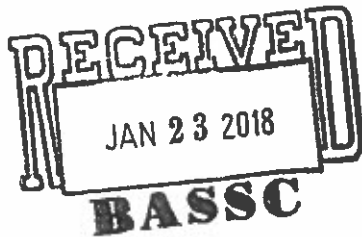

A DIVISION OF GALLAGHER BASSETT SERVICES, INC.

1550 Hubbard Ave., Batavia, IL 60510, 630-879-3006



**TABLE OF CONTENTS**

INTRODUCTION ..... 1

RESULTS ..... 1

PROFESSIONAL CERTIFICATION ..... 1

Appendix I: Sample Locations and Sample Map

Appendix II: Laboratory Results



## **INTRODUCTION**

Belleville Area Special Services Cooperative (BASSC) implemented a proactive program of water testing at BASSC Grade School. Water sampling was conducted by Mr. Andy Antonellis an Aires associate consultant on November 22, 2017. Mr. Geoffrey J. Bacci II, P.E. designed the studied and developed this report.

All sampling methodology followed protocol required by The Lead in Drinking Water Testing Bill (LDWTB) an guidelines published by the Illinois Department of Public Health (IDPH). Detailed background information on testing requirements, methodology and lead health effects are included in the main report to the District that summarizes results and offers recommendations.

## **RESULTS**

Field sheets identifying sample numbers and sample locations maps are included in Appendix I. Laboratory results are included in Appendix II.

All results were less than 5 parts per billion (ppb). Results ranged from non-detectable (< 2 ppb) to 2.83 ppb.

Results should at minimum be posted on the Districts website within 7 days. The sample results should be e-mailed to IDPH within 7 days.

An incoming water sample was collected at the water main. This sample was not representative of drinking water because they contained sediment and rust. These samples are not subject to Notification requirements of the LDWTB.

## **PROFESSIONAL CERTIFICATION**

Aires Consulting, a division of Gallagher Bassett Services, Inc. conducted this study in the interest of Belleville Area Special Services Cooperative (BASSC) to assist in meeting environmental obligations and regulations. In this respect, we hope the results of this study are useful. *This study was not intended to include every environmental*



*exposure that may be present at the facility; only those items specifically addressed in the report were evaluated.* If you have any questions concerning this study please let us know.

Respectfully Submitted,



---

Geoffrey J. Bacci, II, PE  
Director of Operations









ISBE ID: \_\_\_\_\_  
 Building ID: N/A  
 Building Description: BAASC Grade School  
 Sample Collection Date: \_\_\_\_\_  
 Collected by: Andy Antonelli-5

Sample Time (12 HR Clock)	Sample ID Number	Sample Location Description	Fixture Type	Date of Last Use	Time of Last Use (12 HR Clock)	Sample Type	Sample Volume (mL)
9:05	IS-10	Incognito	Faucet	11/21/17	4:00 PM	Grab	1 L Need PH
9:08	KS-11A	Kitchen Sink	Sink	"	"	"	250 mL
9:09	KS-11B	"	"	"	"	"	"
9:12	KS-12A	"	"	"	"	"	"
9:13	KS-12B	"	"	"	"	"	"
9:15	KS-13A	"	"	"	"	"	"
9:15	KS-13B	"	"	"	"	"	"
9:20	TS-14A	Lounge Sink	"	"	"	"	"
9:21	TS-14B	"	"	"	"	"	"
9:23	SN-15A	Sink - Rm-11	"	"	"	"	"
9:24	SN-15B	Sink - Rm-11	"	"	"	"	"
9:30	WF-16A	Water Fountain	Hall Fountain	"	"	"	"
9:31	WF-16B	"	"	"	"	"	"
9:32	WF-17A	"	"	"	"	"	"
9:32	WF-17B	"	"	"	"	"	"







# Elementary

CONCEPTUAL FLOOR PLAN

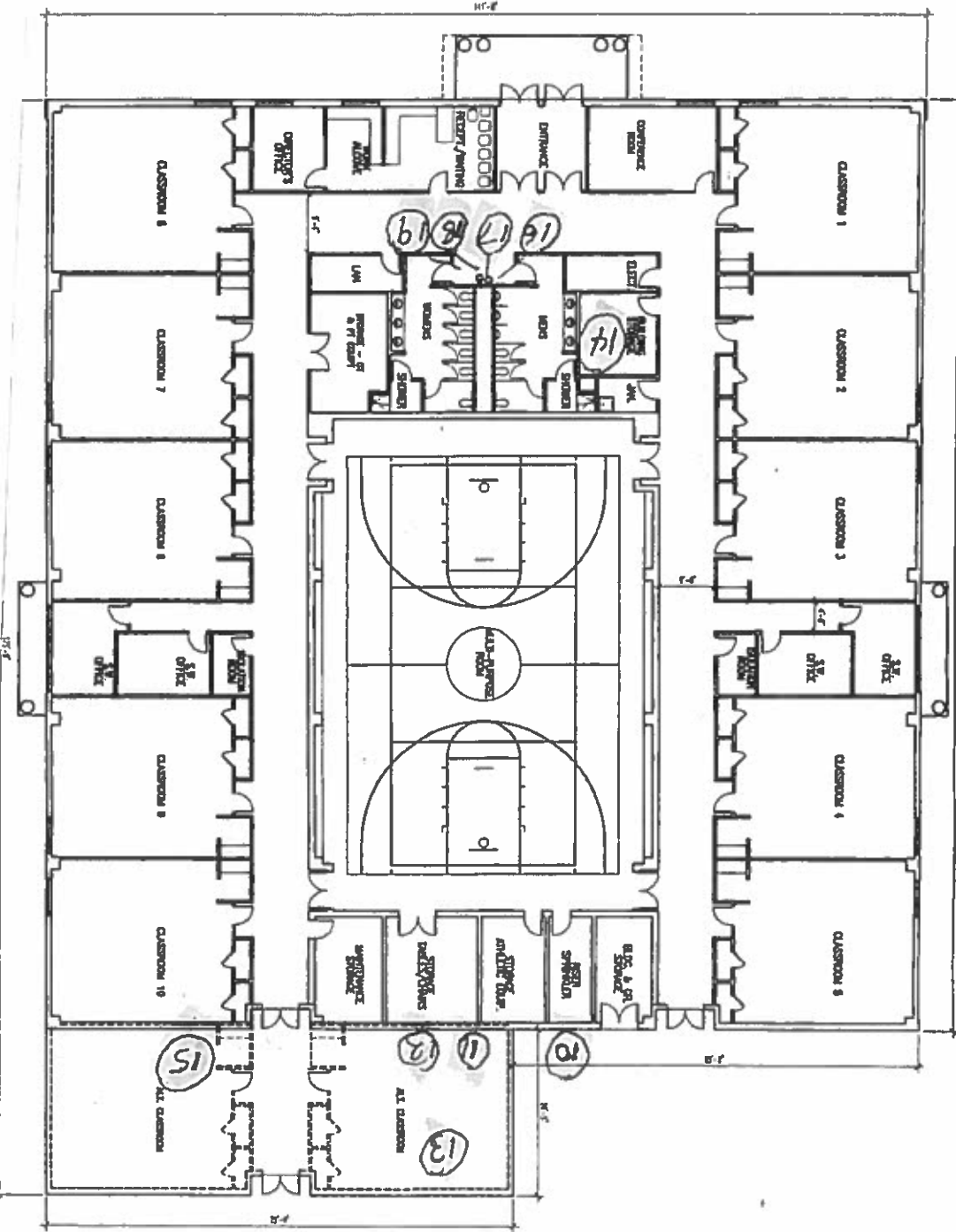

Go To NEAREST wall in Hall way  
 AWAY FROM ANY GLASS  
 Close Doors AND Windows

3







Thursday, December 7, 2017

Geoff Bacci II  
Aires Consulting Group  
1550 Hubbard Ave.  
Batavia, IL 60510

TEL: (630) 879-3006

FAX: (630) 879-3014

RE: BASSC Grade School/ Belleville

PAS WO: 17K0700

Prairie Analytical Systems, Inc. received 19 sample(s) on 11/25/2017 for the analyses presented in the following report.

All applicable quality control procedures met method specific acceptance criteria unless otherwise noted.

This report shall not be reproduced, except in full, without the prior written consent of Prairie Analytical Systems, Inc.

If you have any questions, please feel free to contact me at (224) 253-1348.

Respectfully submitted,

A handwritten signature in black ink, appearing to read "Christina E. Pierce".

Christina E. Pierce  
Project Manager

Certifications: NELAP/NELAC - IL #100323

---

1210 Capital Airport Drive	*	Springfield, IL 62707	*	1.217.753.1148	*	1.217.753.1152 Fax
9114 Virginia Road Suite #112	*	Lake in the Hills, IL 60156	*	1.847.651.2604	*	1.847.458.0538 Fax

Prairie Analytical Systems, Inc.

Date: 12/7/2017

## LABORATORY RESULTS

Client: Aires Consulting Group  
 Project: BASSC Grade School/ Belleville  
 Client Sample ID: IS-10  
 Collection Date: 11/22/17 9:05

Lab Order: 17K0700  
 Lab ID: 17K0700-01  
 Matrix: Drinking Water

Analyses	Result	Limit	Qual	Units	DF	Date Prepared	Date Analyzed	Method	Analyst
<b>Metals by ICP-MS</b>									
*Lead	12.7	2.00		µg/L	1	11/30/17 13:01	11/30/17 19:33	EPA200.8 R5.	JTC
<b>Conventional Chemistry Parameters</b>									
*pH	7.27	0.0100		pH Units	1	11/27/17 13:40	11/27/17 13:42	EPA150.1	cdm

Client Sample ID: KS-11 A  
 Collection Date: 11/22/17 9:08

Lab ID: 17K0700-02  
 Matrix: Drinking Water

Analyses	Result	Limit	Qual	Units	DF	Date Prepared	Date Analyzed	Method	Analyst
<b>Metals by ICP-MS</b>									
*Lead	U	2.00		µg/L	1	11/30/17 13:05	11/30/17 19:51	EPA200.8 R5.	JTC

Client Sample ID: KS-11 B  
 Collection Date: 11/22/17 9:09

Lab ID: 17K0700-03  
 Matrix: Drinking Water

Analyses	Result	Limit	Qual	Units	DF	Date Prepared	Date Analyzed	Method	Analyst
<b>Metals by ICP-MS</b>									
*Lead	U	2.00		µg/L	1	11/30/17 13:05	11/30/17 19:59	EPA200.8 R5.	JTC

Client Sample ID: KS-12 A  
 Collection Date: 11/22/17 9:12

Lab ID: 17K0700-04  
 Matrix: Drinking Water

Analyses	Result	Limit	Qual	Units	DF	Date Prepared	Date Analyzed	Method	Analyst
<b>Metals by ICP-MS</b>									
*Lead	2.83	2.00		µg/L	1	11/30/17 8:00	11/30/17 19:14	EPA200.8 R5.	KSH

Client Sample ID: KS-12 B  
 Collection Date: 11/22/17 9:13

Lab ID: 17K0700-05  
 Matrix: Drinking Water

Analyses	Result	Limit	Qual	Units	DF	Date Prepared	Date Analyzed	Method	Analyst
<b>Metals by ICP-MS</b>									
*Lead	U	2.00		µg/L	1	11/30/17 13:05	11/30/17 20:02	EPA200.8 R5.	JTC

Client Sample ID: KS-13 A  
 Collection Date: 11/22/17 9:15

Lab ID: 17K0700-06  
 Matrix: Drinking Water

Analyses	Result	Limit	Qual	Units	DF	Date Prepared	Date Analyzed	Method	Analyst
<b>Metals by ICP-MS</b>									
*Lead	U	2.00		µg/L	1	11/30/17 13:05	11/30/17 20:05	EPA200.8 R5.	JTC

Client Sample ID: KS-13 B  
 Collection Date: 11/22/17 9:15

Lab ID: 17K0700-07  
 Matrix: Drinking Water

Analyses	Result	Limit	Qual	Units	DF	Date Prepared	Date Analyzed	Method	Analyst
----------	--------	-------	------	-------	----	---------------	---------------	--------	---------

Prairie Analytical Systems, Inc.

Date: 12/7/2017

## LABORATORY RESULTS

Client: Aires Consulting Group  
 Project: BASSC Grade School/ Belleville  
 Client Sample ID: KS-13 B  
 Collection Date: 11/22/17 9:15

Lab Order: 17K0700  
 Lab ID: 17K0700-07  
 Matrix: Drinking Water

Analyses	Result	Limit	Qual	Units	DF	Date Prepared	Date Analyzed	Method	Analyst
Metals by ICP-MS									
*Lead	U	2.00		µg/L	1	11/30/17 13:05	11/30/17 20:08	EPA200.8 R5.	JTC

Client Sample ID: TS-14 A  
 Collection Date: 11/22/17 9:20

Lab ID: 17K0700-08  
 Matrix: Drinking Water

Analyses	Result	Limit	Qual	Units	DF	Date Prepared	Date Analyzed	Method	Analyst
Metals by ICP-MS									
*Lead	U	2.00		µg/L	1	11/30/17 13:05	11/30/17 20:11	EPA200.8 R5.	JTC

Client Sample ID: TS-14 B  
 Collection Date: 11/22/17 9:21

Lab ID: 17K0700-09  
 Matrix: Drinking Water

Analyses	Result	Limit	Qual	Units	DF	Date Prepared	Date Analyzed	Method	Analyst
Metals by ICP-MS									
*Lead	U	2.00		µg/L	1	11/30/17 13:05	11/30/17 20:14	EPA200.8 R5.	JTC

Client Sample ID: SN-15 A  
 Collection Date: 11/22/17 9:23

Lab ID: 17K0700-10  
 Matrix: Drinking Water

Analyses	Result	Limit	Qual	Units	DF	Date Prepared	Date Analyzed	Method	Analyst
Metals by ICP-MS									
*Lead	U	2.00		µg/L	1	11/30/17 13:05	11/30/17 20:17	EPA200.8 R5.	JTC

Client Sample ID: SN-15 B  
 Collection Date: 11/22/17 9:24

Lab ID: 17K0700-11  
 Matrix: Drinking Water

Analyses	Result	Limit	Qual	Units	DF	Date Prepared	Date Analyzed	Method	Analyst
Metals by ICP-MS									
*Lead	U	2.00		µg/L	1	11/30/17 13:05	11/30/17 20:31	EPA200.8 R5.	JTC

Client Sample ID: WF-16 A  
 Collection Date: 11/22/17 9:30

Lab ID: 17K0700-12  
 Matrix: Drinking Water

Analyses	Result	Limit	Qual	Units	DF	Date Prepared	Date Analyzed	Method	Analyst
Metals by ICP-MS									
*Lead	U	2.00		µg/L	1	11/30/17 13:05	11/30/17 20:34	EPA200.8 R5.	JTC

Client Sample ID: WF-16 B  
 Collection Date: 11/22/17 9:31

Lab ID: 17K0700-13  
 Matrix: Drinking Water

Analyses	Result	Limit	Qual	Units	DF	Date Prepared	Date Analyzed	Method	Analyst
Metals by ICP-MS									
*Lead	U	2.00		µg/L	1	11/30/17 13:05	11/30/17 20:37	EPA200.8 R5.	JTC

Prairie Analytical Systems, Inc.

Date: 12/7/2017

## LABORATORY RESULTS

Client:	Aires Consulting Group	Lab Order:	17K0700						
Project:	BASSC Grade School/ Belleville								
<b>Client Sample ID:</b>	WF-17 A	<b>Lab ID:</b>	17K0700-14						
<b>Collection Date:</b>	11/22/17 9:32	<b>Matrix:</b>	Drinking Water						
Analyses	Result	Limit	Qual	Units	DF	Date Prepared	Date Analyzed	Method	Analyst
<b>Metals by ICP-MS</b>									
*Lead	U	2.00		µg/L	1	11/30/17 13:05	11/30/17 20:46	EPA200.8 R5.	JTC
<b>Client Sample ID:</b>	WF-17 B	<b>Lab ID:</b>	17K0700-15						
<b>Collection Date:</b>	11/22/17 9:32	<b>Matrix:</b>	Drinking Water						
Analyses	Result	Limit	Qual	Units	DF	Date Prepared	Date Analyzed	Method	Analyst
<b>Metals by ICP-MS</b>									
*Lead	U	2.00		µg/L	1	11/30/17 13:05	11/30/17 20:48	EPA200.8 R5.	JTC
<b>Client Sample ID:</b>	WF-18 A	<b>Lab ID:</b>	17K0700-16						
<b>Collection Date:</b>	11/22/17 9:35	<b>Matrix:</b>	Drinking Water						
Analyses	Result	Limit	Qual	Units	DF	Date Prepared	Date Analyzed	Method	Analyst
<b>Metals by ICP-MS</b>									
*Lead	U	2.00		µg/L	1	11/30/17 13:05	11/30/17 20:51	EPA200.8 R5.	JTC
<b>Client Sample ID:</b>	WF-18 B	<b>Lab ID:</b>	17K0700-17						
<b>Collection Date:</b>	11/22/17 9:36	<b>Matrix:</b>	Drinking Water						
Analyses	Result	Limit	Qual	Units	DF	Date Prepared	Date Analyzed	Method	Analyst
<b>Metals by ICP-MS</b>									
*Lead	U	2.00		µg/L	1	11/30/17 13:05	11/30/17 20:54	EPA200.8 R5.	JTC
<b>Client Sample ID:</b>	WF-19 A	<b>Lab ID:</b>	17K0700-18						
<b>Collection Date:</b>	11/22/17 9:37	<b>Matrix:</b>	Drinking Water						
Analyses	Result	Limit	Qual	Units	DF	Date Prepared	Date Analyzed	Method	Analyst
<b>Metals by ICP-MS</b>									
*Lead	U	2.00		µg/L	1	11/30/17 13:05	11/30/17 20:57	EPA200.8 R5.	JTC
<b>Client Sample ID:</b>	WF-19 B	<b>Lab ID:</b>	17K0700-19						
<b>Collection Date:</b>	11/22/17 9:38	<b>Matrix:</b>	Drinking Water						
Analyses	Result	Limit	Qual	Units	DF	Date Prepared	Date Analyzed	Method	Analyst
<b>Metals by ICP-MS</b>									
*Lead	U	2.00		µg/L	1	11/30/17 13:05	11/30/17 21:09	EPA200.8 R5.	JTC

Prairie Analytical Systems, Inc.

Date: 12/7/2017

## LABORATORY RESULTS

Client: Aires Consulting Group  
 Project: BASSC Grade School/ Belleville

Lab Order: 17K0700

## Metals by ICP-MS - Quality Control

Analyte	Result	Reporting Limit	Units	Spike Level	Source Result	%REC	%REC Limits	RPD	RPD Limit	Notes
<b>Batch A007750 - EPA 200.8 Metals</b>										
<b>Blank (A007750-BLK1)</b>										
Prepared & Analyzed: 11/30/201										
Lead	U	2.00	µg/L							
<b>LCS (A007750-BS1)</b>										
Prepared & Analyzed: 11/30/201										
Lead	459	2.00	µg/L	500.00		92	85-115			
<b>Matrix Spike (A007750-MS1)</b>										
Source: 17K0233-04 Prepared & Analyzed: 11/30/201										
Lead	525	2.00	µg/L	500.00	71.2	91	75-125			
<b>Matrix Spike Dup (A007750-MSD1)</b>										
Source: 17K0233-04 Prepared & Analyzed: 11/30/201										
Lead	515	2.00	µg/L	500.00	71.2	89	75-125	2	20	
<b>Batch A007760 - EPA 200.8 Metals</b>										
<b>Blank (A007760-BLK1)</b>										
Prepared & Analyzed: 11/30/201										
Lead	U	2.00	µg/L							
<b>LCS (A007760-BS1)</b>										
Prepared & Analyzed: 11/30/201										
Lead	443	2.00	µg/L	500.00		89	85-115			
<b>Matrix Spike (A007760-MS1)</b>										
Source: 17K0625-09 Prepared & Analyzed: 11/30/201										
Lead	429	2.00	µg/L	500.00	2.42	85	75-125			
<b>Matrix Spike (A007760-MS2)</b>										
Source: 17K0699-07 Prepared & Analyzed: 11/30/201										
Lead	399	2.00	µg/L	500.00	0.213	80	75-125			
<b>Matrix Spike Dup (A007760-MSD1)</b>										
Source: 17K0625-09 Prepared & Analyzed: 11/30/201										
Lead	425	2.00	µg/L	500.00	2.42	84	75-125	1	20	

LABORATORY RESULTS

Client: Aires Consulting Group
Project: BASSC Grade School/ Belleville

Lab Order: 17K0700

Metals by ICP-MS - Quality Control

Table with columns: Analyte, Result, Reporting Limit, Units, Spike Level, Source Result, %REC, %REC Limits, RPD, RPD Limit, Notes. Rows include Batch A007760 - EPA 200.8 Metals, Matrix Spike Dup (A007760-MSD2), Batch A007761 - EPA 200.8 Metals, Blank (A007761-BLK1), LCS (A007761-BS1), Matrix Spike (A007761-MS1), Matrix Spike (A007761-MS2), Matrix Spike Dup (A007761-MSD1), Matrix Spike Dup (A007761-MSD2).

Prairie Analytical Systems, Inc.

Date: 12/7/2017

## LABORATORY RESULTS

Client: Aires Consulting Group

Project: BASSC Grade School/ Belleville

Lab Order: 17K0700

## Conventional Chemistry Parameters - Quality Control

Analyte	Result	Reporting Limit	Units	Spike Level	Source Result	%REC	%REC Limits	RPD	RPD Limit	Notes
<b>Batch A007647 - EPA 150.1/SM 4500-H B/SW 9040B pH</b>										
<b>Duplicate (A007647-DUP1)</b>										
		Source: 17K0699-01			Prepared & Analyzed: 11/27/201					
pH	7.23	0.0100	pH Units		7.23			0.04	5	
<b>Duplicate (A007647-DUP2)</b>										
		Source: 17K0700-01			Prepared & Analyzed: 11/27/201					
pH	7.25	0.0100	pH Units		7.27			0.3	5	

Prairie Analytical Systems, Inc.

Date: 12/7/2017

---

---

**LABORATORY RESULTS**

**Client:** Aires Consulting Group

**Project:** BASSC Grade School/ Belleville

**Lab Order:** 17K0700

---

**Notes and Definitions**

- \* NELAC certified compound.
- U Analyte not detected (i.e. less than RL or MDL).



**Chain of Custody Record**

Central IL - 1211 Capital Airport Drive - Springfield, IL 62707-8190 - Phone (217) 753-1148 - Facsimile (217) 753-1152  
 Chicago IL Office - 9114 Virginia Rd., Ste 112 - Lake in the Hills, IL 60156 - Phone (847) 651-2604 - Facsimile (847) 458-0600  
 Central / Southern IL Contact - Phone (217) 414-7762 - Facsimile (217) 753-1152



Client		Aires Consulting - Gallagher Bassett																																						
Address		1550 Hubbard Ave																																						
City, State, Zip Code		Batavia, IL 60510																																						
Phone / Fax		630.879.3006																																						
Project Name / Number		BASSC Grade School 17-18340																																						
Project Location		Belleville, IL																																						
P.O. # or Invoice To		17-18340																																						
Contact Person		Geoff Bacci II																																						
Sample Description	Sampling	Main Code	Preserv Code	No. of Containers	Sample Type																																			
	Date	Time		Comp	Grab																																			
See attached Addendum ( pages) for sample information ( samples)																																								
<p><b>Unless otherwise noted:</b></p> <p>Matrix Code: DW/                  Preservative Code: 0                  No. of containers per sample: 1                  Sample Type: Grab                  Analysis requested: Lead in Drinking Water</p>																																								
<table border="1"> <tr> <td>Matrix Code</td> <td>A - Aqueous</td> <td>DW - Drinking Water</td> <td>GW - Ground Water</td> </tr> <tr> <td>Preservative Code</td> <td>0 - None</td> <td>1 - HCl</td> <td>2 - H2SO4</td> </tr> <tr> <td>Received By</td> <td colspan="2">Date</td> <td>Time</td> </tr> <tr> <td>Ary Antonellis</td> <td colspan="2">11/24/17</td> <td>10:30 am</td> </tr> <tr> <td>Received By</td> <td colspan="2">Date</td> <td>Time</td> </tr> <tr> <td>Mya</td> <td colspan="2">11-25-17</td> <td>9:00</td> </tr> </table>						Matrix Code	A - Aqueous	DW - Drinking Water	GW - Ground Water	Preservative Code	0 - None	1 - HCl	2 - H2SO4	Received By	Date		Time	Ary Antonellis	11/24/17		10:30 am	Received By	Date		Time	Mya	11-25-17		9:00											
Matrix Code	A - Aqueous	DW - Drinking Water	GW - Ground Water																																					
Preservative Code	0 - None	1 - HCl	2 - H2SO4																																					
Received By	Date		Time																																					
Ary Antonellis	11/24/17		10:30 am																																					
Received By	Date		Time																																					
Mya	11-25-17		9:00																																					
<table border="1"> <tr> <td>MA - Non-Aqueous Liquid</td> <td>3 - HNO3</td> <td>4 - NaOH</td> <td>5 - Solid</td> <td>5 - 5035 Kit</td> <td>O - Oil</td> <td>X - Other (Specify)</td> </tr> <tr> <td>Lead in Drinking Water - IL</td> <td></td> <td></td> <td></td> <td></td> <td></td> <td>X - Other (Specify)</td> </tr> <tr> <td colspan="6">Method of Shipment</td> <td>Appendix I</td> </tr> <tr> <td colspan="6">Turnaround Time: Standard <input type="checkbox"/> Rush <input type="checkbox"/></td> <td>Temperature (°C)</td> </tr> <tr> <td colspan="6">Date Required:</td> <td>20</td> </tr> </table>						MA - Non-Aqueous Liquid	3 - HNO3	4 - NaOH	5 - Solid	5 - 5035 Kit	O - Oil	X - Other (Specify)	Lead in Drinking Water - IL						X - Other (Specify)	Method of Shipment						Appendix I	Turnaround Time: Standard <input type="checkbox"/> Rush <input type="checkbox"/>						Temperature (°C)	Date Required:						20
MA - Non-Aqueous Liquid	3 - HNO3	4 - NaOH	5 - Solid	5 - 5035 Kit	O - Oil	X - Other (Specify)																																		
Lead in Drinking Water - IL						X - Other (Specify)																																		
Method of Shipment						Appendix I																																		
Turnaround Time: Standard <input type="checkbox"/> Rush <input type="checkbox"/>						Temperature (°C)																																		
Date Required:						20																																		

ISBE ID: \_\_\_\_\_  
 Building ID: N/A  
 Building Description: BAASC Grate School  
 Sample Collection Date: \_\_\_\_\_  
 Collected by: Andy Antonelli

Sample Time (12 HR Clock)	Sample ID Number	Sample Location Description	Fixture Type	Date of Last Use	Time of Last Use (12 HR Clock)	Sample Type	Sample Volume (mL)
9:05	IS-10	Toileting	Faucet	11/21/17	4:00 PM	Grab	1 L Need PH
9:08	KS-11A	Kitchen/Sink	Sink	"	"	"	250 ML
9:09	KS-11B	"	"	"	"	"	"
9:12	KS-12A	"	"	"	"	"	"
9:13	KS-12B	"	"	"	"	"	"
9:15	KS-13A	"	"	"	"	"	"
9:15	KS-13B	"	"	"	"	"	"
9:20	TS-14A	Lounge Sink	"	"	"	"	"
9:21	TS-14B	"	"	"	"	"	"
9:23	SN-15A	Sink - RM-11	"	"	"	"	"
9:24	SN-15B	Sink - RM-11	"	"	"	"	"
9:30	WE-16A	Water Fountain	Hall Fountain	"	"	"	"
9:31	WE-16B	"	"	"	"	"	"
9:32	WE-17A	"	"	"	"	"	"
9:32	WE-17B	"	"	"	"	"	"

Appendix II



[

[

[

[

[

[

[

[

[

[

[

[

[

[

[

[

[

[

[